

Architectural Door Accessories

Pemko ADB Door Bottom Seal

The global leader in door opening solutions

Automatic, Handed:

412_RL

Surface Mounted

About Door Bottom Seals:

Consist of an aluminum case which surrounds a movable drop bar seal. The drop bar seal is actuated by a plunger which contacts the jamb as the door is closing, forcing the drop bar seal down against the floor or threshold.



↑
Seals
Bottom
of Door

- Low closing force.
- Provide excellent seals to keep out draft, dust, moisture, insects, fumes, light and sound.
- End plates provided for all mounting applications.

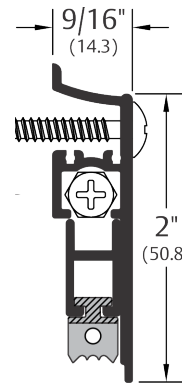

Product Finishes:

- 412BRL** Extruded Bronze [Brass] Anodized Aluminum with Black Sponge Neoprene insert
- 412CRL** Clear Anodized Aluminum with Black Sponge Neoprene insert
- 412DRL** Dark Bronze Anodized Aluminum with Black Sponge Neoprene insert
- 412SRL** Clad Stainless Steel with Black Sponge Neoprene insert

Tools Required:

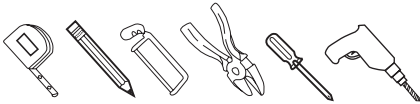

Parts Included In End Plate Kit:

Number	Description	Quantity
1	Fasteners	5
2	End Plate	1

Testing/Ratings:



Pemko ADB Door Bottom Seal

The global leader in
door opening solutions

Installation Instructions

All models may be reversed for left-or-right hand installations. Disassembly and reassembly of the mechanism is required to reverse the handing.

WARNING: You must determine the hand and reverse the mechanism (if required) prior to cutting down the unit to fit the door.

REVERSE HANDING (See figure 1)

1. Remove the small anchoring screw on the back of the unit.
2. Slide out the drop bar and plunger assemblies together.
3. Replace these assemblies in the opposite end.
4. Line up the hole in the end anchor with the pre-drilled hole in the case.
5. Replace the anchoring screw.

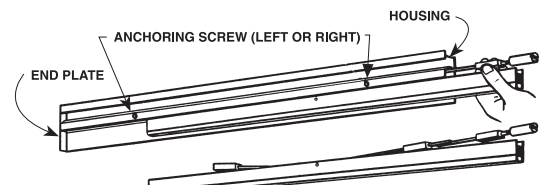

Figure 1 - Reversing the Mechanism

CUT / INSTALL ADB

1. Cut ADB 1/8" less than the distance between the stops (without cutting gasketing insert).

NOTE: When cutting, make sure that the drop bar is flush with the case on the plunger side. Do not trim the gasket yet.

WARNING: ADB less than 24" CAN ONLY be cut down by 1/2".

WARNING: ADB 24" and over should NOT be cut down more than 2".

WARNING: ADB should ONLY be cut from non-plunger side.

2. Adjust and trim the gasketing insert so that it fits fully in the case, between the end plates without dragging.
3. Place the ADB so that the plunger contacts the stop (see Figure 2).
4. Fasten with mounting screws provided.

a) The actuation plunger should be located on the hinge side of the door.

b) The bottom of the ADB case should be installed flush with the door bottom.

5. For wood jambs, a #10 x 1/2" flat head screw is furnished for installation at the point where the plunger contacts the jamb to prevent indenting.
6. Screw the actuating plunger in or out as required until the gasketing insert just touches the sealing surface when the door is closed.

NOTE: Adjustment range is 1/8" min - 3/4" max

NOTE: Start with the plunger screwed in completely to avoid over adjustment or damage.

WARNING: Do not over adjust the plunger. It is only necessary to lightly compress the insert gaskets against the sealing surface to provide proper sealing. Over adjustment can cause internal component failure voiding the warranty!

WARNING: Do NOT use power tools to adjust the ADB!

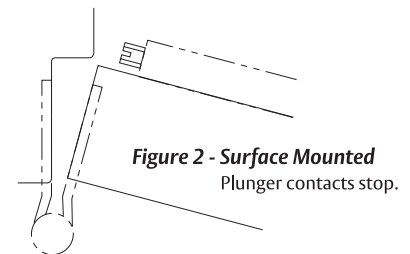

Figure 2 - Surface Mounted
Plunger contacts stop.

Pemko ADB Door Bottom Seal

The global leader in
door opening solutions

End Plate Installation Instructions:

PLEASE READ THESE INSTRUCTIONS THOROUGHLY BEFORE ATTEMPTING TO INSTALL END PLATES.

The automatic door bottom must be correctly installed and adjusted in accordance with the installation instructions furnished with this product (see other side).

1. Make sure that the drop bar (part that contains the seal) does not project beyond the end of the case when the actuation plunger is depressed. If it does project beyond the case, it was improperly trimmed in the field. This condition can be corrected by removing the unit and trimming the excess.

WARNING: Under NO condition should the drop bar project beyond the edge of the case.

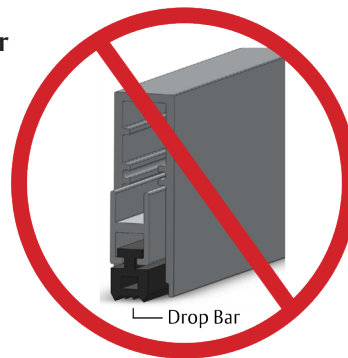

Figure 3 - Improper Drop Bar
This shows an improper drop bar protruding from the end of the case. The drop bar should be flush at both ends.

2. Install the flat end plate on the lock edge of the door with the fasteners provided.
3. Install the end plate opposite the plunger, with the “This Side In” sticker towards the ADB, using the end plate screws as shown in Figure 4.

WARNING: Do NOT use power tools to tighten screws!

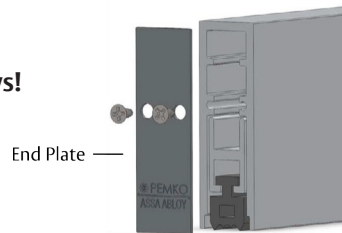

Figure 4 - Properly Installed End Plate
This shows a properly installed end plate.

4. On the plunger side, with the “This Side In” sticker towards the ADB, align the end plate’s hexagonal hole with the plunger and install using the end plate screws as shown in Figure 5

NOTE: Plunger end plate prevents the plunger from rotating and changing adjustment. This plate may be removed for readjustment later if needed.

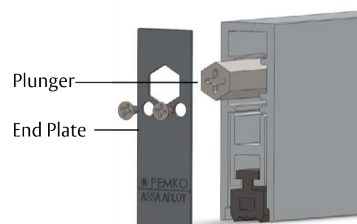

Figure 5
Plunger end plate prevents the plunger adjustment from rotating.